

H CHIMNEY CAP

ART. 1200

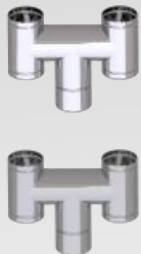

STAINLESS
STEEL

GALVANIZED

Usage of the product:

The H chimney cap protects the flue from infiltration of rain water or snow whilst permitting the emission of combustion fumes even in the presence of high wind. Also available on a square base.

Installation instructions:

Install on the terminal part of the chimney flue. Fix by means of a flue clamp. Do not use a silicon sealant only. Installation of the chimney cap must be carried out by qualified personnel.

Available for Single Wall flue pipes, both male and female.

Conforms to UNI 7129/01 sez. 4-3-3 regulations regarding chimney caps.

EC Certifications in conformity with EN 1856-1 :
- Resistance to flow.

Art. 1200

Ø	80	100	120	130	140	150	160	180	200
H	270	280	330	360	380	390	410	500	560
A	330	370	470	500	530	550	580	680	750

